



ADATA Industrial & Embedded Solutions

M.2 SSD

The ultra-compact IM2S3314 M.2 2242 solid state drive is optimized for industrial applications, especially those operating in extreme-temperature environments. With wide-temperature resistance (-40°C to 85°C) it offers excellent endurance and durability, even in harsh surroundings. What's more, ADATA's proprietary A+ SLC technology ensures optimal SSD performance, stability and a lifespan that's up to three times longer than many MLC drives. This all brings the IM2S3314 up to par with SLC drives while also providing cost savings of up to 80%. With S.M.A.R.T., TRIM Command, and NCQ technologies, the IM2S3314 maintains data integrity and improves overall storage and system performance. To safeguard quality, compatibility, and reliability, ADATA utilizes a rigorous SSD validation process that encompasses performance testing and quality assurance to ensure all its SSDs meet the exacting requirements of industrial applications.

Key Features

- Ultra-compact M.2 2242 form factor
- Supports A+ SLC Mode: emulates SLC performance on MLC Flash
- Diverse capacities: (MLC) 32GB-256GB; (A+ SLC) 16GB-128GB
- Wide-Temperature Support: -40°C to 85°C
- P/E Cycle up to 3K for high durability and reliability
- Employs WD (SanDisk) OG IC
- BCH ECC supported



Target Applications

Industrial PCs, Transportation, Automation, Embedded System, Networking, Medical, Aerospace

30μ Golden Finger	Anti-Sulfur Resistor	Conformal Coating	Wide Temperature	EDS & EMI Safe	Shock & Vibration Resistant	Lifetime Monitoring (LTM)	Wear Leveling	Secure Erase	TRIM	Low Power Consumption
●	●	●	●	●	●	●	●	●	●	●

● Supported

Specifications

Model	IM2S3314
Interface	SATA III
Form Factor	M.2 2242
Dimensions (L x W x H)	42 x 22 x 3.5mm
Flash Type	MLC / A+ SLC
Capacity	(MLC) 32GB / 64GB / 128GB / 256GB (A+ SLC) 16GB / 32GB / 64GB / 128GB
Sequential Read (Max.)	540MB/s
Sequential Write (Max.)	450MB/s
Operating Temperature (Commercial)	0°C to 70°C
Operating Temperature (Industrial)	-40°C to 85°C
Operating Voltage	3.3V
Operating Humidity	5%-95% RH non-condensing
Power Consumption (Max.)	2.5W
MTBF (Est.)	>2,000,000 hours
Shock Resistance	1500G/0.5ms, Half Sine Wave
Vibration Resistance	20G (10-2000Hz)
Technologies	S.M.A.R.T., NCQ and TRIM Command, Wear Leveling

Ordering Information

Capacity	MLC	MLC
	Commercial (0°C to 70°C)	Industrial (-40°C to 85°C)
32GB	IM2S3314-032GM	IM2S3314-032GT
64GB	IM2S3314-064GM	IM2S3314-064GT
128GB	IM2S3314-128GM	IM2S3314-128GT
256GB	IM2S3314-256GM	IM2S3314-256GT
Capacity	A+ SLC	A+ SLC
	Commercial (0°C to 70°C)	Industrial (-40°C to 85°C)
16GB	IM2S3314-016GA	IM2S3314-016GE
32GB	IM2S3314-032GA	IM2S3314-032GE
64GB	IM2S3314-064GA	IM2S3314-064GE
128GB	IM2S3314-128GA	IM2S3314-128GE

Dimensions

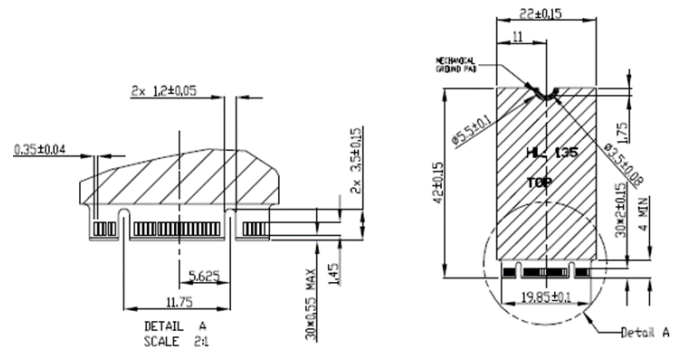

ADATA Technology
2F, No. 258, Liancheng Rd., Zhonghe Dist.,
New Taipei City 235, Taiwan